

ONYX® 2" High Temperature, Standard Magnetics

Metric Specifications

Construction

| | |
|--------------|---------------------|
| Anode | 304 Stainless Steel |
| Cathode Body | OFHC Copper |
| Insulator | Ceramic |

Cooling Requirements

| | |
|------------------------------------|----------|
| Flow Rate at Maximum Power | 0.05 LPS |
| Maximum Input Pressure, Open Drain | 4 BAR |
| Maximum Input Temperature | 20 °C |

Dimensions

| | |
|---|---------|
| A | 71.5 mm |
| B | 78.0 mm |
| C | 19.1 mm |

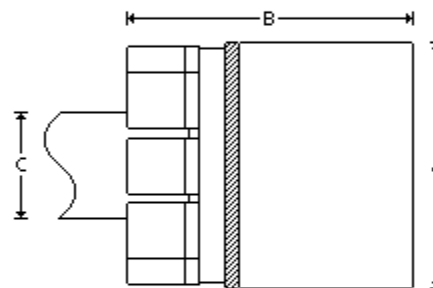

General

| | |
|-------------------------------------|--------------------------------|
| Magnetic Enhancement | Permanent (NdFeB) Encapsulated |
| Maximum Temperature | 200 °C |
| Source to Substrate Distance | 50.8 mm - 304.8 mm |
| Weight, Approximate Without Options | 1.4 kg |

Maximum Sputtering Power *

| | |
|--------------------------|------------------|
| Cathode Voltage | 100 - 1500 Volts |
| Discharge Current | 0.1 - 2 Amps |
| Indirect Cooled Mode, DC | 1 kW |
| Indirect Cooled Mode, RF | 600 Watts |
| Operating Pressure | 0.5 - 50 mTorr |

Mounting, Standard

| | |
|-------------------------------|-------------------------------------|
| Power Cable, DC | 1675A |
| Power Cable, RF | 1675A |
| Power Connector, DC | Type N Connector, External Threads |
| Power Connector, RF | Type HN Connector, External Threads |
| Stem, Outer Dimension Tubing | 19.1 mm |
| Water, Outer Dimension Tubing | 6.4 mm |

Target

| | |
|-----------|-------------------|
| Cooling | Indirect |
| Diameter | 50.8 mm |
| Form | Circular / Planar |
| Thickness | 0.3 mm - 9.6 mm |

Specifications Disclaimer

- All Angstrom Sciences NdFeB magnets are totally encapsulated and protected from degradation by water.
 - All sources are available in external configurations.
 - * Maximum power for cathode only, a target material's properties, such as, thermal and electrical conductivity may limit the maximum process power level.
 - Some custom-engineered and specialty magnetrons may not meet standard specifications.
 - Specifications are subject to change without notice.
 - Typical performance. Results may vary with process parameters such as pressure, flow rate, target material, and substrate rotation, etc.
-

Please contact us for specifications regarding your application.

Angstrom Sciences | Call +1-412-469-8466 | www.angstromsciences.com